

PHARMALOK™ Sanitary Clamps

The biopharmaceutical industry has made a strong move towards single-use technology, so Nordson MEDICAL has developed PharmaLok™ sanitary clamps to simplify and streamline biopharma processes. Effortlessly and securely attach sanitary fittings to bag ports and filters with PharmaLok™ sanitary clamps.

FEATURES & BENEFITS

- 360° uniform compression ensures consistent sealing
- Connects both plastic and stainless-steel fittings
- Easy-to-use, one-handed closure - no tools required in most cases
- Latch lockout holds standard cable ties
- ASME BPE 018 DT-7-1 and SIP/CIP compatible

PharmaLok™ Zero

- Universal compatibility supports a wide range of fittings and flanges
- Single-setting latch simplifies operation - no tools, torque checks, or adjustments required
- Up to 25% less material than traditional TC clamps
- Adaptive closure accommodates gasket and flange variations
- Minimized particulate
- Compact design with nested latch and hinges eliminates protrusions

SPECIFICATIONS

- **Material:**
Zytel® FGFE5171 glass-filled nylon certified to USP Class VI and ISO 10993
- **Temperature and Sterilization**
Normal operating temperature -94° F (-70° C) to 140° F (60° C)
Cryogenic freezing to -112° F (-80° C)
Autoclavable up to 273° F (134° C) for a maximum of 30 min.
Gamma radiation up to 50 kGy
X-ray sterilization up to 50 kGy
- **Sizes:**
0.5" (12.7 mm) to 0.75" (19.0 mm)
1" (25.4 mm) to 1.5" (31.8 mm)
3" (76.2 mm)
4" (101.6 mm)
- **Operating Pressure:**
80 psi - 100 psi

PHARMALOK™ Sanitary Clamps

PHARMALOK™ ZERO UNIVERSAL CLAMPS

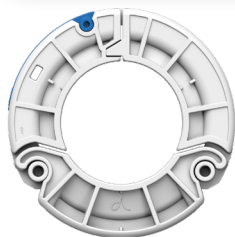

CPUX150-U71

Hygienic Union PharmaLok™ ZerO TC Clamp, 1" (25.4 mm) to 1.5" (38.1 mm), Glass-Reinforced White Nylon, Blue Lever, Maxi Flange



CPUN075-U71

Hygienic Union PharmaLok™ ZerO TC Clamp, 0.5" (12.7 mm) to 0.75" (19.0 mm) Glass-Reinforced White Nylon, Blue Lever, Mini Flange

EASY-OPEN CLAMPS

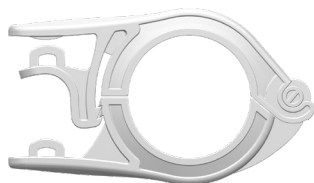

CPAX150 (-U71, -U75, -U706)

Tri-Clover Easy-Open Clamp for Maxi Flange, 1" (25.4 mm) to 1.5" (38.1 mm), Glass-Reinforced White, Blue, or Orange Nylon



CPAN75 (-U71, -U75, -U706)

Tri-Clover Easy-Open Clamp for Mini Flange, 0.5" (12.7 mm) to 0.75" (19.0 mm), Glass-Reinforced White, Blue, or Orange Nylon

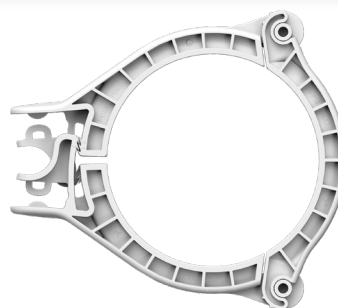

CPAX400 (-U71)

Tri-Clover Easy-Open Clamp for 4" (101.6 mm) Flange, Glass-Reinforced White Nylon

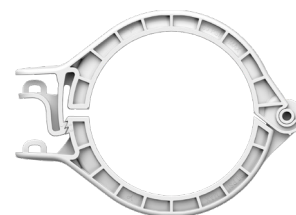

CPAX300 (-U71)

Tri-Clover Easy-Open Clamp for 3" (76.2 mm) Flange, Glass-Reinforced White Nylon

SINGLE-USE CLAMPS

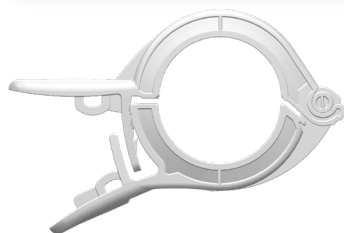

CPX150 (-U71)

Single-Use Series Clamp, TC Version 1" (25.4 mm) to 1.5" (38.1 mm), Glass-Reinforced White Nylon



CPN75 (-U71)

Single-Use Series Clamp, TC Version 0.5" (12.7 mm) to 0.75" (19.0 mm), Glass-Reinforced White Nylon